

08

TECHNICAL
SHEET

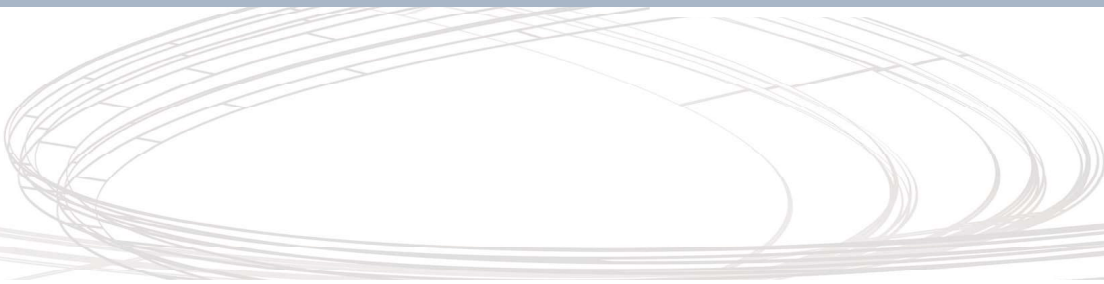

FLAT BOTTOM
SILOS

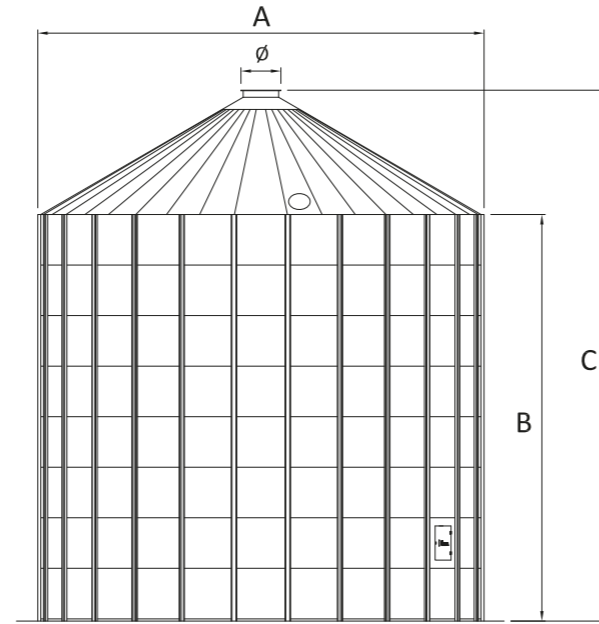

INDOOR
SILOS

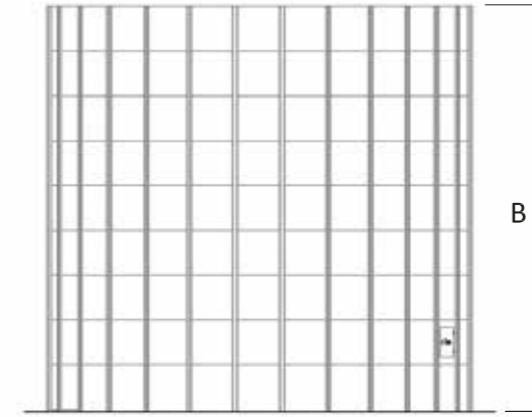

SBH - FLAT BOTTOM SILO - VOLUME

| FLAT BOTTOM SILOS | SILO Ø (m) A | 3,00 | 3,50 | 4,60 | 5,35 | 6,10 | 6,87 | 7,60 | 8,40 | 9,20 | 9,93 | 10,70 | 11,45 | 12,23 | 12,98 | 13,75 | 14,51 | 15,28 | 16,04 | 16,80 | 17,57 | 18,34 | 19,86 | 20,62 | 21,39 | 22,15 | 22,92 | 23,68 | 24,44 | 25,98 | 27,50 | 32,08 | | | | | |
|----------------------|--------------------------|--------------|-------|-------|-------|-------|-------|-------|-------|-------|-------|-------|-------|-------|-------|-------|-------|-------|--------|--------|--------|--------|--------|--------|--------|--------|--------|--------|--------|--------|--------|--------|--|--|--|--|--|
| | ALTURA DEL TECHO (m) C-B | 0,69 | 0,79 | 1,26 | 1,48 | 1,69 | 1,92 | 2,14 | 2,36 | 2,59 | 2,81 | 3,03 | 3,25 | 3,47 | 3,70 | 3,90 | 4,13 | 4,35 | 4,56 | 4,79 | 5,10 | 5,30 | 5,77 | 5,99 | 6,21 | 6,41 | 6,65 | 6,87 | 7,09 | 7,53 | 7,65 | 8,96 | | | | | |
| RINGS NUMBER | CYLINDRICAL HEIGHT (M) B | VOLUMEN (m³) | | | | | | | | | | | | | | | | | | | | | | | | | | | | | | | | | | | |
| 4 | 4,61 | 35 | 47 | 83 | 115 | 152 | 195 | 244 | 299 | 361 | 430 | 505 | 587 | 677 | 774 | 878 | 991 | 1.111 | 1.229 | 1.377 | 1.530 | 1.684 | 2.024 | 2.206 | 2.401 | 2.601 | 2.816 | 3.040 | 3.273 | 3.773 | 4.252 | 6.143 | | | | | |
| 5 | 5,75 | 44 | 58 | 102 | 140 | 185 | 237 | 296 | 363 | 437 | 518 | 608 | 705 | 811 | 925 | 1.047 | 1.179 | 1.320 | 1.459 | 1.630 | 1.807 | 1.985 | 2.377 | 2.587 | 2.810 | 3.040 | 3.287 | 3.542 | 3.808 | 4.377 | 4.930 | 7.064 | | | | | |
| 6 | 6,89 | 52 | 69 | 121 | 166 | 219 | 280 | 349 | 426 | 512 | 606 | 710 | 823 | 944 | 1.076 | 1.216 | 1.368 | 1.529 | 1.689 | 1.883 | 2.083 | 2.286 | 2.731 | 2.968 | 3.220 | 3.480 | 3.757 | 4.044 | 4.343 | 4.981 | 5.607 | 7.986 | | | | | |
| 7 | 8,03 | 60 | 80 | 140 | 192 | 252 | 322 | 401 | 489 | 587 | 695 | 812 | 940 | 1.078 | 1.227 | 1.386 | 1.557 | 1.738 | 1.920 | 2.135 | 2.359 | 2.587 | 3.084 | 3.348 | 3.630 | 3.919 | 4.227 | 4.547 | 4.878 | 5.585 | 6.284 | 8.908 | | | | | |
| 8 | 9,17 | 69 | 91 | 158 | 217 | 286 | 364 | 453 | 552 | 662 | 783 | 915 | 1.058 | 1.212 | 1.378 | 1.555 | 1.745 | 1.947 | 2.150 | 2.388 | 2.636 | 2.888 | 3.437 | 3.729 | 4.040 | 4.359 | 4.698 | 5.049 | 5.413 | 6.189 | 6.961 | 9.830 | | | | | |
| 9 | 10,31 | 77 | 102 | 177 | 243 | 319 | 407 | 505 | 616 | 738 | 871 | 1.017 | 1.175 | 1.346 | 1.529 | 1.724 | 1.934 | 2.156 | 2.380 | 2.641 | 2.912 | 3.189 | 3.790 | 4.110 | 4.449 | 4.798 | 5.168 | 5.551 | 5.948 | 6.794 | 7.639 | 10.751 | | | | | |
| 10 | 11,45 | 85 | 113 | 196 | 268 | 353 | 449 | 558 | 679 | 813 | 960 | 1.120 | 1.293 | 1.480 | 1.680 | 1.894 | 2.123 | 2.365 | 2.611 | 2.894 | 3.189 | 3.490 | 4.144 | 4.490 | 4.859 | 5.238 | 5.638 | 6.053 | 6.483 | 7.398 | 8.316 | 11.673 | | | | | |
| 11 | 12,59 | 94 | 124 | 215 | 294 | 386 | 491 | 610 | 742 | 888 | 1.048 | 1.222 | 1.410 | 1.613 | 1.832 | 2.063 | 2.311 | 2.574 | 2.841 | 3.147 | 3.465 | 3.791 | 4.497 | 4.871 | 5.269 | 5.677 | 6.109 | 6.555 | 7.018 | 8.002 | 8.993 | 12.595 | | | | | |
| 12 | 13,73 | 102 | 135 | 234 | 320 | 419 | 534 | 662 | 805 | 963 | 1.136 | 1.325 | 1.528 | 1.747 | 1.983 | 2.232 | 2.500 | 2.783 | 3.071 | 3.400 | 3.742 | 4.092 | 4.850 | 5.252 | 5.678 | 6.117 | 6.579 | 7.058 | 7.553 | 8.606 | 9.670 | 13.517 | | | | | |
| 13 | 14,87 | 110 | 146 | 252 | 345 | 453 | 576 | 714 | 869 | 1.039 | 1.225 | 1.427 | 1.646 | 1.881 | 2.134 | 2.402 | 2.688 | 2.929 | 3.302 | 3.653 | 4.018 | 4.393 | 5.203 | 5.632 | 6.088 | 6.556 | 7.049 | 7.560 | 8.089 | 9.210 | 10.347 | 14.439 | | | | | |
| 14 | 16,01 | 119 | 157 | 271 | 371 | 486 | 618 | 767 | 932 | 1.114 | 1.313 | 1.529 | 1.763 | 2.015 | 2.285 | 2.571 | 2.877 | 3.201 | 3.532 | 3.906 | 4.294 | 4.694 | 5.557 | 6.013 | 6.498 | 6.996 | 7.520 | 8.062 | 8.624 | 9.814 | 11.025 | 15.360 | | | | | |
| 15 | 17,15 | 127 | 168 | 290 | 396 | 520 | 661 | 819 | 995 | 1.189 | 1.401 | 1.632 | 1.881 | 2.149 | 2.436 | 2.740 | 3.066 | 3.410 | 3.763 | 4.159 | 4.571 | 4.995 | 5.910 | 6.394 | 6.907 | 7.435 | 7.990 | 8.564 | 9.159 | 10.418 | 11.702 | 16.282 | | | | | |
| 16 | 18,29 | 179 | 309 | 422 | 553 | 703 | 871 | 1.058 | 1.264 | 1.490 | 1.734 | 1.998 | 2.282 | 2.587 | 2.909 | 3.254 | 3.619 | 3.993 | 4.412 | 4.847 | 5.296 | 6.263 | 6.775 | 7.317 | 7.875 | 8.460 | 9.066 | 9.694 | 11.022 | 12.379 | 17.204 | | | | | | |
| 17 | 19,43 | 190 | 328 | 448 | 587 | 745 | 923 | 1.122 | 1.340 | 1.578 | 1.837 | 2.116 | 2.416 | 2.738 | 3.079 | 3.443 | 3.828 | 4.223 | 4.665 | 5.124 | 5.597 | 6.616 | 7.155 | 7.727 | 8.314 | 8.931 | 9.569 | 10.229 | 11.626 | 13.056 | 18.126 | | | | | | |
| 18 | 20,57 | 347 | 473 | 620 | 788 | 976 | 1.185 | 1.415 | 1.666 | 1.939 | 2.234 | 2.550 | 2.889 | 3.248 | 3.632 | 4.037 | 4.454 | 4.918 | 5.400 | 5.898 | 6.970 | 7.536 | 8.136 | 8.754 | 9.401 | 10.071 | 10.764 | 12.230 | 13.733 | 19.047 | | | | | | | |
| 19 | 21,71 | 365 | 499 | 654 | 830 | 1.028 | 1.248 | 1.490 | 1.755 | 2.042 | 2.351 | 2.684 | 3.040 | 3.417 | 3.820 | 4.246 | 4.684 | 5.170 | 5.677 | 6.199 | 7.323 | 7.917 | 8.546 | 9.193 | 9.871 | 10.573 | 11.299 | 12.834 | 14.411 | 19.969 | | | | | | | |
| 20 | 22,85 | 384 | 524 | 687 | 872 | 1.080 | 1.311 | 1.565 | 1.843 | 2.144 | 2.469 | 2.817 | 3.191 | 3.587 | 4.009 | 4.455 | 4.914 | 5.423 | 5.953 | 6.500 | 7.676 | 8.297 | 8.956 | 9.633 | 10.341 | 11.075 | 11.834 | 13.439 | 15.088 | 20.891 | | | | | | | |
| 21 | 23,99 | 403 | 550 | 720 | 915 | 1.133 | 1.374 | 1.641 | 1.931 | 2.246 | 2.586 | 2.951 | 3.342 | 3.756 | 4.198 | 4.664 | 5.145 | 5.676 | 6.230 | 6.801 | 8.029 | 8.678 | 9.366 | 10.072 | 10.812 | 11.577 | 12.370 | 14.043 | 15.765 | 21.813 | | | | | | | |
| 22 | 25,13 | 422 | 576 | 720 | 957 | 1.185 | 1.438 | 1.716 | 2.019 | 2.349 | 2.704 | 3.085 | 3.493 | 3.925 | 4.386 | 4.873 | 5.375 | 5.929 | 6.506 | 7.102 | 8.383 | 9.059 | 9.775 | 10.512 | 11.282 | 12.080 | 12.905 | 14.647 | 16.442 | 22.735 | | | | | | | |
| 23 | 26,27 | 441 | 601 | 787 | 999 | 1.237 | 1.501 | 1.791 | 2.108 | 2.451 | 2.822 | 3.219 | 3.644 | 4.095 | 4.575 | 5.082 | 5.605 | 6.182 | 6.782 | 7.403 | 8.736 | 9.439 | 10.185 | 10.951 | 11.752 | 12.582 | 13.440 | 15.251 | 17.119 | 23.656 | | | | | | | |
| 24 | 27,41 | 627 | 821 | 1.042 | 1.289 | 1.564 | 1.866 | 2.196 | 2.554 | 2.939 | 3.353 | 3.795 | 4.264 | 4.763 | 5.221 | 5.836 | 6.435 | 7.059 | 7.704 | 9.089 | 9.820 | 10.595 | 11.391 | 12.223 | 13.084 | 13.975 | 15.855 | 17.797 | 24.578 | | | | | | | | |
| 25 | 28,55 | 653 | 854 | 1.084 | 1.342 | 1.627 | 1.942 | 2.284 | 2.656 | 3.057 | 3.486 | 3.946 | 4.433 | 4.952 | 5.500 | 6.066 | 6.688 | 7.335 | 8.005 | 9.442 | 10.201 | 11.004 | 11.830 | 12.693 | 13.586 | 14.510 | 16.459 | 18.474 | 25.500 | | | | | | | | |
| 26 | 29,69 | 678 | 888 | 1.126 | 1.394 | 1.691 | 2.017 | 2.373 | 2.759 | 3.174 | 3.620 | 4.097 | 4.602 | 5.141 | 5.709 | 6.296 | 6.941 | 7.612 | 8.306 | 9.796 | 10.581 | 11.414 | 12.270 | 13.163 | 14.088 | 15.045 | 17.063 | 19.151 | | | | | | | | | |
| 27 | 30,83 | 921 | 1.169 | 1.446 | 1.754 | 2.092 | 2.461 | 2.861 | 3.292 | 3.754 | 4.248 | 4.772 | 5.329 | 5.918 | 6.527 | 7.194 | 7.888 | 8.607 | 10.149 | 10.962 | 11.824 | 12.709 | 13.634 | 14.590 | 15.580 | 17.667 | 19.828 | | | | | | | | | | |
| 28 | 31,97 | 955 | 1.211 | 1.498 | 1.817 | 2.167 | 2.549 | 2.963 | 3.409 | 3.888 | 4.399 | 4.941 | 5.518 | 6.127 | 6.757 | 7.447 | 8.165 | 8.908 | 10.502 | 11.343 | 12.233 | 13.148 | 14.104 | 15.093 | | | | | | | | | | | | | |
| 29 | 33,11 | 988 | 1.253 | 1.551 | 1.880 | 2.243 | 2.638 | 3.066 | 3.527 | 4.022 | 4.550 | 5.110 | 5.707 | 6.336 | 6.988 | 7.700 | 8.441 | 9.209 | 10.855 | | | | | | | | | | | | | | | | | | |
| 30 | 34,25 | 1.022 | 1.296 | 1.603 | 1.943 | 2.318 | 2.726 | 3.168 | 3.645 | 4.155 | 4.701 | 5.280 | 5.895 | 6.545 | 7.218 | 7.953 | 8.717 | | | | | | | | | | | | | | | | | | | | |

Mass-Discharge Silos. Silo calculated according to NF-P-22-630 standard.

Indoor silos. Available with diameters ranging 3m to 12.23m, with the following SBI models: 3.00, 3.50, 4.60, 5.35, 6.10, 6.87, 7.60, 8.40, 9.20, 9.93, 10.7, 11.45 y 12.23. Maximum height for SBI is limited to 10 rings of body sheets, or 11,45m. SBI silos are marked in grey in technical data table.

Silos capacity are calculated assuming a 27° angle of repose. Silos are designed to comply with wind loads of 100 kg / m², snow loads of 80 kg / m² on the roof.

SILOS WITH HOPPER

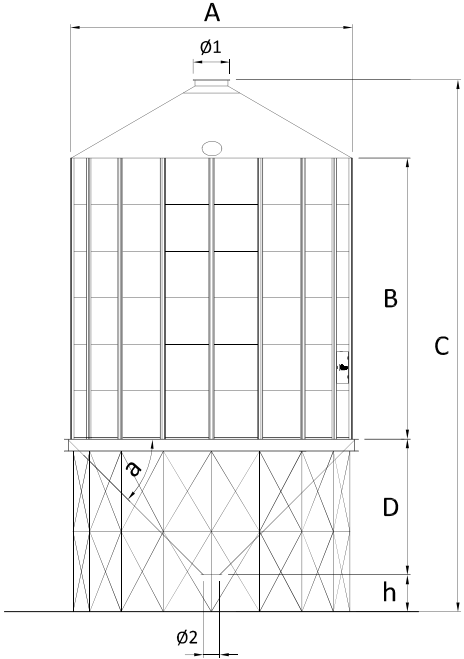

SCE - T45 - 400 - VOLUME - h = 900 mm

| HOPPER SILOS T-45 | SILO Ø (m) A | 4,60 | 5,35 | 6,10 | 6,87 | 7,60 | 8,40 | 9,20 | 9,93 | 10,70 | 11,45 | 12,23 |
|----------------------|--------------------------|-------------|------|-------|-------|-------|-------|-------|-------|-------|-------|-------|
| | OUTPUT Ø2 (mm) | 400 | 400 | 400 | 400 | 400 | 400 | 400 | 400 | 400 | 400 | 400 |
| | HOPPER HEIGHT (m) D | 2,18 | 2,57 | 2,54 | 3,33 | 3,72 | 4,11 | 4,48 | 4,86 | 5,36 | 5,74 | 6,12 |
| | ROOF HEIGHT (m) | 1,26 | 1,48 | 1,69 | 1,92 | 2,14 | 2,36 | 2,59 | 2,81 | 3,03 | 3,25 | 3,47 |
| RINGS NUMBER | CYLINDRICAL HEIGHT (M) B | VOLUME (m³) | | | | | | | | | | |
| 4 | 4,61 | 95 | 134 | 180 | 236 | 300 | 375 | 459 | 554 | 665 | 784 | 915 |
| 5 | 5,75 | 114 | 159 | 214 | 278 | 353 | 438 | 534 | 643 | 767 | 901 | 1049 |
| 6 | 6,89 | 133 | 185 | 247 | 321 | 405 | 501 | 610 | 731 | 869 | 1019 | 1183 |
| 7 | 8,03 | 151 | 211 | 281 | 363 | 457 | 565 | 685 | 819 | 972 | 1136 | 1316 |
| 8 | 9,17 | 170 | 236 | 314 | 405 | 509 | 628 | 760 | 908 | 1074 | 1254 | 1450 |
| 9 | 10,31 | 189 | 262 | 348 | 448 | 562 | 691 | 835 | 996 | 1177 | 1371 | 1584 |
| 10 | 11,45 | 208 | 287 | 381 | 490 | 614 | 754 | 911 | 1084 | 1279 | 1489 | 1718 |
| 11 | 12,59 | 227 | 311 | 414 | 532 | 666 | 817 | 986 | 1173 | 1382 | 1607 | 1852 |
| 12 | 13,73 | 245 | 339 | 448 | 575 | 719 | 881 | 1061 | 1261 | 1484 | 1724 | 1985 |
| 13 | 14,87 | 264 | 364 | 481 | 617 | 771 | 944 | 1136 | 1349 | 1586 | 1842 | 2.119 |
| 14 | 16,01 | 283 | 390 | 515 | 659 | 823 | 1007 | 1212 | 1438 | 1689 | 1959 | 2.253 |
| 15 | 17,15 | 302 | 415 | 548 | 702 | 875 | 1070 | 1287 | 1526 | 1791 | 2.077 | 2.387 |
| 16 | 18,29 | 321 | 441 | 582 | 744 | 928 | 1.134 | 1.362 | 1.614 | 1.894 | 2.195 | 2.521 |
| 17 | 19,43 | 340 | 467 | 615 | 786 | 980 | 1.197 | 1.437 | 1.703 | 1.996 | 2.312 | 2.654 |
| 18 | 20,57 | 358 | 492 | 649 | 829 | 1.032 | 1.260 | 1.513 | 1.791 | 2.099 | 2.430 | 2.788 |
| 19 | 21,71 | 377 | 518 | 682 | 871 | 1.084 | 1.323 | 1.588 | 1.879 | 2.201 | 2.547 | 2.922 |
| 20 | 22,85 | 396 | 543 | 716 | 913 | 1.137 | 1.387 | 1.663 | 1.968 | 2.304 | 2.665 | 3.056 |
| 21 | 23,99 | 415 | 569 | 749 | 956 | 1.189 | 1.450 | 1.738 | 2.056 | 2.406 | 2.783 | 3.190 |
| 22 | 25,13 | 434 | 595 | 789 | 998 | 1.241 | 1.513 | 1.814 | 2.144 | 2.508 | 2.900 | 3.323 |
| 23 | 26,27 | 452 | 620 | 816 | 1.040 | 1.293 | 1.576 | 1.889 | 2.233 | 2.611 | 3.018 | 3.457 |
| 24 | 27,41 | | 646 | 849 | 1.083 | 1.346 | 1.640 | 1.964 | 2.321 | 2.713 | 3.135 | 3.591 |
| 25 | 28,55 | | 671 | 883 | 1.125 | 1.398 | 1.703 | 2.040 | 2.409 | 2.816 | 3.253 | 3.725 |
| 26 | 29,69 | | 697 | 916 | 1.167 | 1.450 | 1.766 | 2.115 | 2.492 | 2.918 | 3.370 | 3.858 |
| 27 | 30,83 | | | 950 | 1.210 | 1.502 | 1.829 | 2.190 | 2.586 | 3.021 | 3.488 | 3.992 |
| 28 | 31,97 | | | 983 | 1.252 | 1.555 | 1.892 | 2.265 | 2.674 | 3.125 | 3.606 | 4.126 |
| 29 | 33,11 | | | 1.017 | 1.294 | 1.607 | 1.956 | 2.341 | 2.762 | 3.225 | 3.723 | 4.260 |
| 30 | 34,25 | | | 1.050 | 1.337 | 1.659 | 2.019 | 2.416 | 2.851 | 3.228 | 3.841 | 4.394 |

SCE - T60 - 1250 - VOLUME - h = 1650 mm

| HOPPER SILOS T60 | SILO Ø (m) A | 4,60 | 5,35 | 6,10 | 6,87 | 7,60 | 8,40 | 9,20 | 9,93 |
|---------------------|--------------------------|-------------|------|-------|-------|-------|-------|-------|-------|
| | OUTPUT Ø2 (mm) | 1250 | 1250 | 1250 | 1250 | 1250 | 1250 | 1250 | 1250 |
| | HOPPER HEIGHT (m) D | 2,98 | 3,62 | 4,28 | 4,93 | 5,63 | 6,30 | 6,96 | 7,62 |
| | ROOF HEIGHT (m) | 1,26 | 1,48 | 1,69 | 1,92 | 2,14 | 2,59 | 2,59 | 2,81 |
| RINGS NUMBER | CYLINDRICAL HEIGHT (M) B | VOLUME (m³) | | | | | | | |
| 4 | 4,61 | 99 | 142 | 193 | 256 | 330 | 415 | 514 | 626 |
| 5 | 5,75 | 118 | 167 | 227 | 298 | 382 | 479 | 589 | 714 |
| 6 | 6,89 | 137 | 193 | 260 | 340 | 434 | 542 | 664 | 802 |
| 7 | 8,03 | 156 | 218 | 294 | 383 | 486 | 605 | 739 | 891 |
| 8 | 9,17 | 175 | 244 | 327 | 425 | 539 | 668 | 815 | 979 |
| 9 | 10,31 | 193 | 270 | 361 | 467 | 591 | 732 | 890 | 1.067 |
| 10 | 11,45 | 212 | 295 | 394 | 510 | 643 | 795 | 965 | 1.156 |
| 11 | 12,59 | 231 | 321 | 428 | 552 | 695 | 858 | 1.040 | 1.244 |
| 12 | 13,73 | 250 | 346 | 461 | 594 | 748 | 921 | 1.116 | 1.332 |
| 13 | 14,87 | 269 | 372 | 494 | 637 | 800 | 985 | 1.191 | 1.421 |
| 14 | 16,01 | 287 | 398 | 528 | 679 | 852 | 1.048 | 1.266 | 1.509 |
| 15 | 17,15 | 306 | 423 | 561 | 721 | 905 | 1.111 | 1.342 | 1.597 |
| 16 | 18,29 | 325 | 449 | 595 | 764 | 957 | 1.174 | 1.417 | 1.686 |
| 17 | 19,43 | 344 | 474 | 628 | 806 | 1.009 | 1.237 | 1.492 | 1.774 |
| 18 | 20,57 | 363 | 500 | 662 | 848 | 1.061 | 1.301 | 1.567 | 1.862 |
| 19 | 21,71 | 382 | 526 | 695 | 891 | 1.114 | 1.364 | 1.643 | 1.951 |
| 20 | 22,85 | 400 | 551 | 729 | 933 | 1.166 | 1.427 | 1.718 | 2.039 |
| 21 | 23,99 | 419 | 577 | 762 | 975 | 1.218 | 1.490 | 1.793 | 2.127 |
| 22 | 25,13 | 438 | 603 | 796 | 1.018 | 1.270 | 1.554 | 1.868 | 2.216 |
| 23 | 26,27 | 457 | 628 | 829 | 1.060 | 1.323 | 1.617 | 1.944 | 2.304 |
| 24 | 27,41 | | 654 | 862 | 1.102 | 1.375 | 1.680 | 2.019 | 2.392 |
| 25 | 28,55 | | 679 | 896 | 1.145 | 1.427 | 1.743 | 2.094 | 2.480 |
| 26 | 29,69 | | 705 | 929 | 1.187 | 1.479 | 1.807 | 2.169 | 2.569 |
| 27 | 30,83 | | | 963 | 1.229 | 1.532 | 1.870 | 2.245 | 2.657 |
| 28 | 31,97 | | | 996 | 1.272 | 1.584 | 1.933 | 2.320 | 2.745 |
| 29 | 33,11 | | | 1.030 | 1.314 | 1.636 | 1.996 | 2.395 | 2.834 |
| 30 | 34,25 | | | 1.063 | 1.356 | 1.688 | 2.060 | 2.470 | 2.922 |

Mass-Discharge Silos. Silo calculated according to NF-P-22-630 standard. Silos capacity are calculated assuming a 27° angle of repose. Silos are designed to comply with wind loads of 100 kg / m² , snow loads of 80 kg / m² on the roof.

SILOS WITH HOPPER NO RING

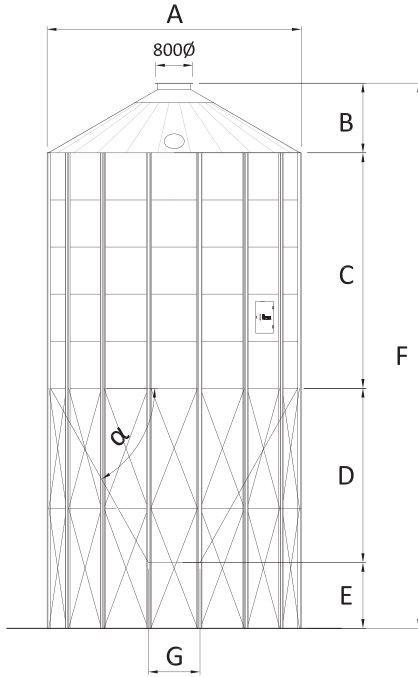

DELIVERY SILOS WITH HOPPER NO RING

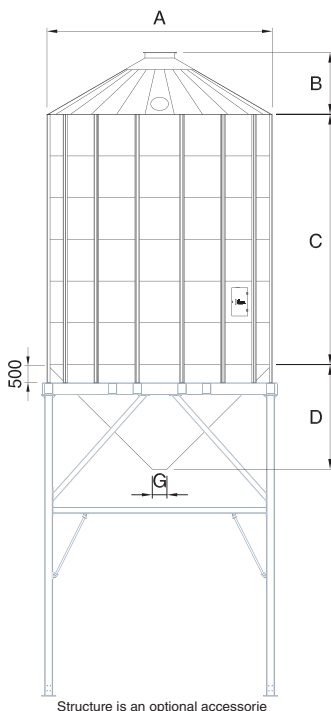

Structure is an optional accessorie

SC - SCPC - T45 - 400 - VOLUME - E = 900

| SILOS WITH HOPPER T45 NO RING | SILO Ø (m) A | 3,00 | 3,50 | 4,60 | 5,35 | 6,10 |
|-------------------------------|--------------------------|--------------------------|------|------|------|------|
| | OUTPUT Ø (mm) G | 400 | 400 | 400 | 400 | 400 |
| | HOPPER HEIGHT (m) D | 1,33 | 1,52 | 2,10 | 2,48 | 2,86 |
| | ROOF HEIGHT (m) B | 0,69 | 0,79 | 1,26 | 1,48 | 1,69 |
| RINGS NUMBER | CYLINDRICAL HEIGHT (M) C | VOLUME (m ³) | | | | |
| 1 | 1,14 | 13 | 18 | 37 | 55 | 78 |
| 2 | 2,28 | 22 | 29 | 56 | 81 | 111 |
| 3 | 3,42 | 30 | 40 | 75 | 107 | 145 |
| 4 | 4,61 | 38 | 51 | 94 | 132 | 178 |
| 5 | 5,75 | 47 | 62 | 113 | 158 | 212 |
| 6 | 6,89 | 55 | 73 | 131 | 183 | |
| 7 | 8,03 | 63 | 84 | 150 | 209 | |
| 8 | 9,17 | 72 | 95 | 169 | | |
| 9 | 10,31 | 80 | 106 | | | |
| 10 | 11,48 | | | | | |

SC - SCPC - T60 - 1250 - VOLUME - E = 1650

| SILOS WITH HOPPER T60 NO RING | SILO Ø (m) A | 4,60 | 5,35 | 6,10 |
|-------------------------------|--------------------------|--------------------------|------|------|
| | OUTPUT Ø (mm) G | 1250 | 1250 | 1250 |
| | HOPPER HEIGHT (m) D | 2,98 | 3,62 | 4,28 |
| | ROOF HEIGHT (m) B | 1,26 | 1,48 | 1,69 |
| RINGS NUMBER | CYLINDRICAL HEIGHT (M) C | VOLUME (m ³) | | |
| 1 | 1,14 | 42 | 63 | 91 |
| 2 | 2,28 | 61 | 89 | 125 |
| 3 | 3,42 | 79 | 115 | 158 |
| 4 | 4,56 | 98 | 140 | 192 |
| 5 | 5,7 | 117 | 166 | 225 |
| 6 | 6,84 | 136 | 191 | 259 |
| 7 | 7,98 | 155 | 217 | |
| 8 | 9,12 | 173 | | |
| 9 | 10,26 | | | |
| 10 | 11,40 | | | |

SC - SCPC - T66 - 1050 - VOLUME

| SILOS WITH HOPPER T66 NO RING | SILO Ø (m) | 3,00 | 3,50 |
|-------------------------------|------------------------|--------------------------|------|
| | OUTPUT Ø (mm) | 1050 | 1050 |
| | HOPPER HEIGHT (m) | 2,25 | 2,71 |
| | ROOF HEIGHT (m) | 0,69 | 0,79 |
| RINGS NUMBER | CYLINDRICAL HEIGHT (M) | VOLUME (m ³) | |
| 1 | 1,14 | 16 | 22 |
| 2 | 2,28 | 24 | 33 |
| 3 | 3,42 | 32 | 44 |
| 4 | 4,56 | 41 | 55 |
| 5 | 5,7 | 49 | 66 |
| 6 | 6,84 | 57 | 77 |
| 7 | 7,98 | 66 | 88 |
| 8 | 9,12 | 74 | 99 |
| 9 | 10,26 | 82 | 110 |
| 10 | 11,40 | | |

Mass-Discharge Silos. Silo calculated according to NF-P-22-630 standard.
Delivery silos. With capacities ranging from 27m³ until 267m³.
 Silos capacity are calculated assuming a 27° angle of repose. Silos are designed to comply with wind loads of 100 kg / m² , snow loads of 80 kg / m² on the roof.



Oficinas y fábrica:

Ctra. de Arenas km. 2,300
13210 Villarta de San Juan • Ciudad Real - Spain
T: +34 926 640 475

Oficina Madrid:

C/ Azcona, 37 • 28028 Madrid - Spain
T: +34 91 726 43 04

symaga@symaga.com
www.symaga.com