

SILO Ø 1.80/3T60 - 6,86 tons

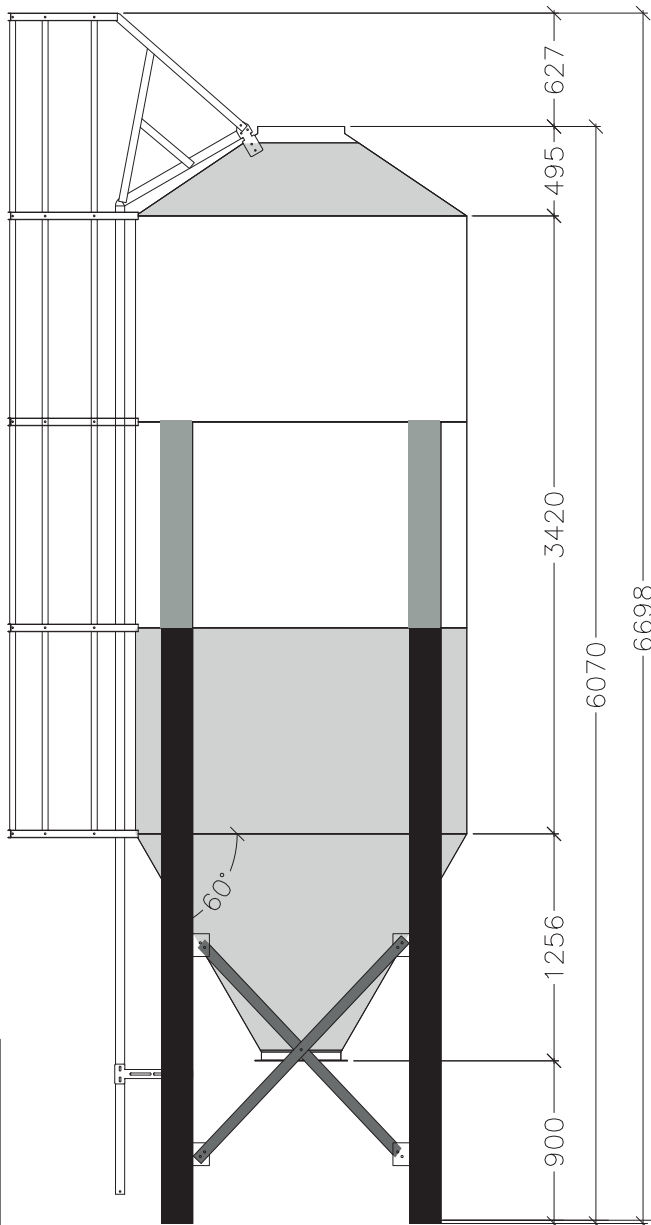

FILE 2.1
VERSION 2. 30/09/2024

COD. SG180G60M3



PARTS AND MATERIALS

- 1 ROOF**
 - Composed by roof sectors assembled between them through screws.
 - Sectors material : Galvanised steel S350GD Z600.
- 2 CYLINDER**
 - Composed by bodysheets screwed between them and with stiffeners.
 - Bodysheet material: Galvanised steel S350GD Z600.
- 3 HOPPER**
 - Hopper sectors screwed between them to form the hopper.
 - Material: Galvanised steel S350 GD Z600 MAC
 - Bracing is composed by "U" profiles cold formed.
 - Slope 60°.
 - Hopper cone diameter is 445mm (clearance 900 mm)
 - Material : Galvanised steel S275 JR e= 3mm + HDG

Model	Ø		N° Rings	Angle of hopper	N° legs	Height to fill			Total height with safety cage			
	m	feet				m	feet	tons*	m	feet		
G01SG180G60M3	1,80	6	3	60	4	10,56	372,92	6,86	6,07	19,91	6,69	21,97

*Capacity in tons is calculated at 0,65 tons/m³, for free flowing material.

Products not considered as free flowing materials not to be stored in these silos (soybean meal, cotton seed meal, hot feeds). Consult Growket technical department when is doubt about specific material.

FOUNDATION

- All instruction shall be considered as recomendations only because the installation may vary according to local conditions.
- Foundation recomendations are based on a minimum 2 kg/cm² ground resistance and on a concrete resistance of 250 kg/cm² at 28 days.
- The foundation site must be free of vegetation and debris and well drained.

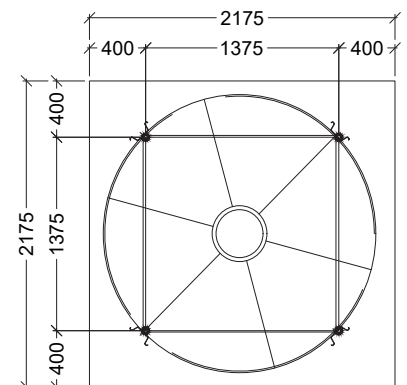
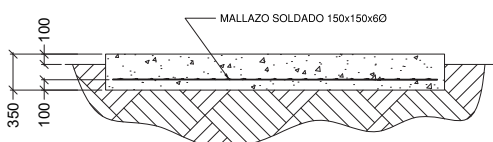

TECHNICAL DATA SG180G60M3