

# TECHNICAL DATA // MECANIC-MINIVEL-SY-SM2

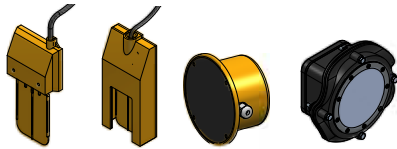

## LEVEL SENSORS

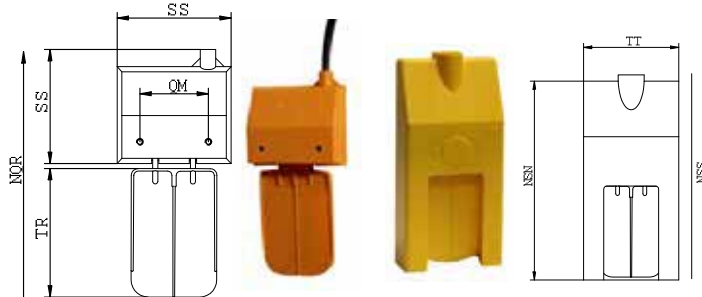

### MECANIC SENSOR

- Sensor with or without box with cable 3x0.5mm of 300mm.
- Recommended for the control of material that is easy to flow and does not compact.
- Fixing by means of screws, to the control unit or hopper.

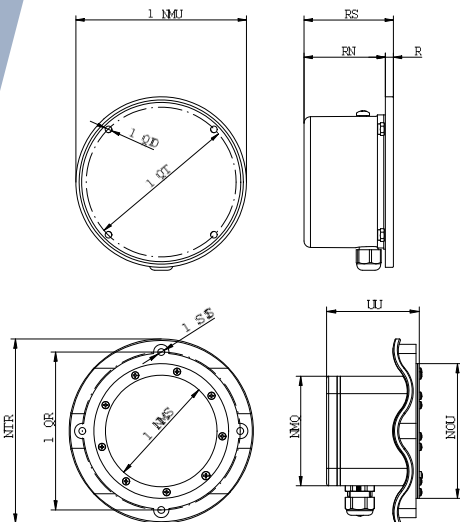

### MINIVEL MEMBRANE SENSOR:

- Level detection in the control unit.
- Fixation by screws.
- Recommended for powdery and granular products with easy flow.

### SY-SM2 MEMBRANE SENSOR:

- To detect the minimum level in hoppers and silos.

REFERENCE	MECANIC	MINIVEL	SY-SM1
<b>Reference</b>	G02004011001 with box G02004011002 without box	G0200404100 1	G01A000S2D01
<b>Density</b>	300 a 2500 kg/m <sup>3</sup>	300 a 2500 kg/m <sup>3</sup>	300 a 2500 kg/m <sup>3</sup>
<b>Work pressure</b>	Atmospheric	Atmospheric	Atmospheric
<b>Cable entrance</b>	Ø5 mm Ø15 mm protective box	Cable glands M12x1,5	Cable glands M20x1,5
<b>Contact voltage</b>	250VAC	250VAC	250VAC
<b>Contact function</b>	1 NA + 1 NC1	NA + 1 NC1	NA + 1 NC
<b>Breaking power</b>	10A/250VAC1	0A/250VAC1	5A/250VAC
<b>Work temperature</b>	-60°C a +125°C	-15°C a +125°C	-15°C a +55°C
<b>Protection</b>	--		IP65
<b>Weight</b>	without box 60g with box 125g	125g	800g
<b>Sensitivity</b>	20g5	0g	200g-1000g ajustable
<b>Protective box</b>	SI	--	
<b>Construction materials</b>	ABSA	BS	PA